



Dogness Rover Automatic Feeder User Manual



BEFORE USING THIS PRODUCT, PLEASE READ THIS MANUAL.

Thank you for purchasing DOGNESS smart products. For your safety and concern, please read this product manual carefully prior to use. Failure to follow and operate this product in accordance within the manual and issues that result in any personal injury, property or other losses, DOGNESS has no liability except as expressly provided by law.

ABOUT THE PRODUCT MANUAL

The authorization, trademark, and font size of the manual belong to DOGNESS and other related parties. If the content of the manual is inconsistent with the actual product (including APP), the actual product (APP) shall prevail. DOGNESS reserves the right (including electronic version) to interpret and modify the manual within the scope permitted by law. If you have any objection to any content or terms of the manual, please submit a written objection to DOGNESS: within 7 days after purchasing the product. Otherwise you agree, understand and accept the entire contents within this user manual.

PRODUCT CONTENTS



Program and customize a feeding plan for you and your pet from the control panel. No internet required.

SPECIFICATIONS

Product Name: Dogness Rover Automatic Feeder
Model: F17-M
Capacity: 4 Liters
Size: L13.8" x W7.99" x H12.68"
Weight: 4.9 lbs.
Material: ABS/ Melamine Bowl
Rechargeable Battery: 2500mAh
Power: 5V 1A
Includes: Feeder, USB Power Cord , Melamine Bowl, User Manual & Warranty.
*Feeder requires a 5V/1A Power Adapter, not included

FEATURES

- **PROGRAMMABLE:** Easy to see and use front control panel, no app or internet required
- **CAPACITY:** Holds up to 4 liters of dry kibble, feeds up to 6 meals per day, 40 portions per meal.
- **CLOG - FREE DISPENSER:** Anti-food jamming design ensures the food is delivered on time, every time.
- **INSECT & MOISTURE-RESISTANT:** Built-in top cover silicone seal keeps the food fresh and dry. The food outlet closure prevent insects from entering while reducing moisture.
- **DUAL-POWER MODE:** Powered with a USB power cord and rechargeable lithium battery, supports wireless use.
- **POWER SAVING DESIGN:** When powered by the battery, the feeder enters "Sleep-Mode" when idle to conserve energy.
- **UNINTERRUPTED POWER SUPPLY:** Maintains the feeding schedule during a power outage.
- **LOW FOOD NOTIFICATION:** Feeder displays a flashing light when the food is level is low.
- **DURABLE:** Break-Resistant, BPA-Free Melamine food bowl. Resists against scratches, chips and stains. Easy to clean and dishwasher safe.
- **REMOVABLE TRANSPARENT BUCKET:** With the transparent bucket it's easy to see the food level. Simple to disassemble and clean.
- **PAW PROOF:** Push-and-pull lid and food outlet closure keep it inaccessible to prying paws.

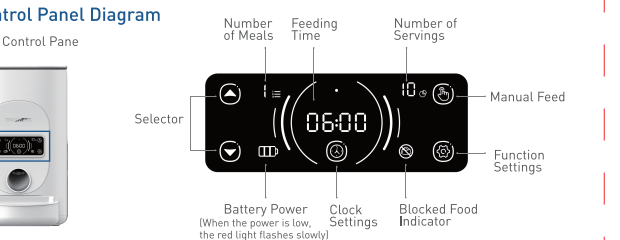
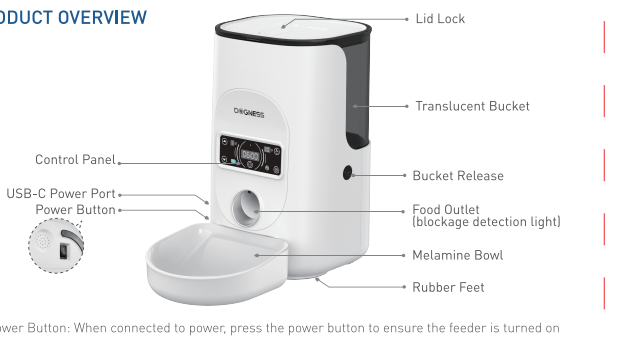

BATTERY POWER LEVEL INDICATOR LIGHTS

Power Level %	0-10%	11-20%	21-79%	80-97%	98-100%
Indicator Light Color	Slow Flashing Red	Solid Red	Solid Yellow	Slow Flashing Green	Solid Green
Battery Power					

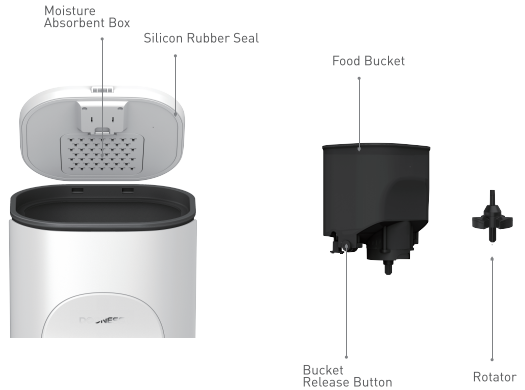

POWER SUPPLY

① USB Power Supply

② Built-In Rechargeable Battery

Sleep mode:

When using battery power, the feeder will enter into "low-power sleep mode" after a short idle period. To save power, the feeders function will be limited but it will maintain the feeding plan as scheduled.

INSTRUCTIONS

1. SET UP THE FEEDER:

- [1] Power ON: connect the USB to the feeders power port, plug the other end to the Power Adapter and into a power outlet.
- [2] Test the Feeder: press and hold the "Manual Feed" button for one second, the motor will rotate 1 portion. Repeat the processs 3 time to ensure the feeder is ready.
- [3] To restore to Factory Settings, press and hold the "Function Settings" button for 3 seconds until it dings three times.

2. SET THE CLOCK:

- [1] Hour: press and hold the "Time" button, then press the "Hour" button to cycle through to set the hour and release.
- [2] Minutes: repeat the same process for the "Minutes" button.

3. SCHEDULE A MEAL:

- [1] Meals: press the "Function Settings" button, when the "Number of Meals" light begins to flash, press the "Up and Down" button to set the number of meals.
- [2] Portions per Meal: Press the "Function Settings" button, when the "Number of Portions" light begins to flash, press the "Up and Down" button to set the portions.
- [3] Time: press the "Function Settings" button, when the "Feeding Time" light begins to flash, press the "Up and Down" button to adjust the hour.Repeat the same process to set the minutes. Once the time is set wait 5 seconds to confirm the schedule.

① CLOCK

The clock uses military time standard. The default time of the feeder is 12:00.
To change the time to 6:10 (for example) do the following:

- [1] HOUR: press the "Clock Settings" button, when the hour digits start to flash, press the "Up and Down" buttons to set hour to 06: and release.
- [2] MINUTES: press the "Clock Settings" button, when the minutes start to flash, press the "Up and Down" button to set the minutes to :10 and release
- [3] Press the "Clock Settings" button again to set the time or simply wait 5 seconds for it to stop flashing.

* Set the clock to the current time prior to use.
Reset the clock when disconnected from power.



② SERVINGS

- [1] DAILY MEALS: press the "Function Setting" button, when the "Number of Meals" starts to flash, press the "Up and Down Selection" button to set the number of daily meals, "1" represents the first meal of the day, a maximum of 6 meals can be set per day.
- [2] SERVINGS PER MEAL :press the "Function Settings" button when the "Number of Serving" starts to flash, press the "Up and Down" button to set the servings. For example; "10" represents 10 the servings per meal. A maximum of 40 servings for each meal.
- [3] SET the HOUR: press the "Function Settings" button, when the "Feeding Time" hour starts to flash press the "Up and Down Selection" button to the hour, release to set (military time standard).
- [4] SET the MINUTE: press the "Function Setting" button, when the "Feeding Time" minute starts to flash, press the "Up and Down" button to the minute, release to set. Wait 5 seconds for the programming to confirm.

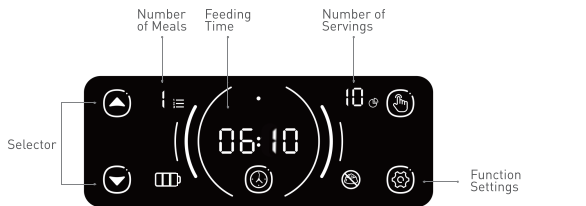

MANUAL FEED

To feed on demand, simply press the "Manual Feed" button to dispense one portion / serving of food.



PRECAUTIONS

1. Fill the feeder with Dry kibble only.
 2. When plugging and unplugging the adapter, do not pull on the power cord directly.
 3. Don't insert foreign objects into the feeder, modify or attempt to repair this product without prior authorization from a Dogness representative.
 4. Please use the original USB power cable.
 5. This product is only suitable for indoor use, avoid direct sunlight exposure.
 6. This device contains electronic parts and is not waterproof. It is not recommended to be used in moist or wet enviroments.
 7. This product is not suitable for any other purposes except feeding pets.
 8. This is not a toy, those who lack relevant experience and knowledge (including children) must use it under the supervision and guidance of a responsible adult.
 9. Clean and maintain this product.
 10. If the product fails or produces smoke, or abnormal heat, please disconnect from power and contact customer service at [US] 1-833-DOGNESS [364-6377].
1. Why does my feeder dispense incorrectly or the display screen is unclear or the function is abnormal?
Answer: ①If only using USB power supply, please ensure that the power supply is normal.
②If battery power is used, this problem occurs after a period of use, mostly due to the low battery level. Please charge it promptly
2. The power supply is normal, but the food doesn't dispense?
Answer: Check the food outlet for any blockage or excessive build-up that could be preventing a smooth food delivery. If the food blockage light is flashing, check for the obvious first.
- 3.How do i clean the feeder?
Answer: Disconnect the feeder from power and use a damp cloth to wipe down feeder, avoid any moisture from entering into the feeders motor, barrel or mechanism.
4. Can the feeder be used outdoors or on a patio?
Answer: The feeder is for indoor use only. The electronic components could be damage if exposed to moisture.

FAQ

名称	F17-M多尼斯漫游者自动喂食器说明书(英文版)		
文件编号	JS21MKTPKD229CH	文件版次	A1
尺寸	630*90mm		
材质工艺	128g哑粉 风琴折		
设计	赖伟全	时间	2023/10/20
审核			